

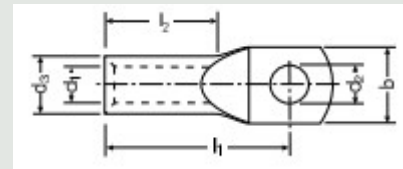

wire size	Stud size	D1	L1	B	I2	D2	D3
16	M 5	5,5	26,0	12,0	13,0	5,3	8,5
16	M 6	5,5	27,0	12,0	13,0	6,4	8,5
16	M 8	5,5	29,0	15,0	13,0	8,4	8,5
16	M 10	5,5	31,0	17,0	13,0	10,5	8,5
16	M 12	5,5	32,5	19,0	13,0	13,2	8,5
25	M 5	7,0	30,0	14,0	15,0	5,3	10,0
25	M 6	7,0	30,0	14,0	15,0	6,4	10,0
25	M 8	7,0	32,5	16,0	15,0	8,4	10,0
25	M 10	7,0	34,5	18,0	15,0	10,5	10,0
25	M 12	7,0	35,5	19,0	15,0	13,2	10,0
25	M 14	7,0	36,5	21,0	15,0	15,0	10,0
35	M 6	8,5	32,5	17,0	17,0	6,4	12,0
35	M 8	8,5	35,0	18,0	17,0	8,4	12,0
35	M 10	8,5	37,0	19,0	17,0	10,5	12,0
35	M 12	8,5	38,0	21,0	17,0	13,2	12,0
35	M 14	8,5	39,5	21,0	17,0	15,0	12,0
35	M 16	8,5	41,0	26,0	17,0	17,0	12,0
50	M 6	10,0	37,0	20,0	19,0	6,4	14,0
50	M 8	10,0	37,0	20,0	19,0	8,4	14,0
50	M 10	10,0	39,0	20,0	19,0	10,5	14,0
50	M 12	10,0	40,0	23,0	19,0	13,2	14,0
50	M 14	10,0	41,5	23,0	19,0	15,0	14,0
50	M 16	10,0	43,0	28,0	19,0	17,0	14,0
50	M 20	10,0	46,0	30,0	19,0	21,0	14,0
70	M 6	12,0	43,0	24,0	21,0	6,4	16,5
70	M 8	12,0	43,0	24,0	21,0	8,4	16,5
70	M 10	12,0	45,0	24,0	21,0	10,5	16,5
70	M 12	12,0	46,0	24,0	21,0	13,2	16,5
70	M 14	12,0	47,5	24,0	21,0	15,0	16,5
70	M 16	12,0	49,0	28,0	21,0	17,0	16,5
70	M 20	12,0	52,0	30,0	21,0	21,0	16,5
95	M 8	13,5	48,0	26,0	25,0	8,4	18,0
95	M 10	13,5	48,0	26,0	25,0	10,5	18,0
95	M 12	13,5	49,0	26,0	25,0	13,2	18,0
95	M 14	13,5	50,5	26,0	25,0	15,0	18,0
95	M 16	13,5	52,0	28,0	25,0	17,0	18,0
95	M 20	13,5	58,0	36,0	25,0	21,0	18,0
120	M 8	15,0	51,0	28,0	26,0	8,4	19,5
120	M 10	15,0	51,0	28,0	26,0	10,5	19,5
120	M 12	15,0	51,0	28,0	26,0	13,2	19,5
120	M 14	15,0	52,0	28,0	26,0	15,0	19,5
120	M 16	15,0	53,0	30,0	26,0	17,0	19,5
120	M 20	15,0	59,0	36,0	26,0	21,0	19,5

Execution	Standard
Material	Cu-ETP – Sn plated
Standard	DIN EN 13600
Temperature	Heat resistant up to 125 degrees Celcius



*Other sizes available on request